



CP10MVNO

BAKERY OVEN 10 TRAYS 600x400 - GN 1/1
MECHANICAL CONTROL + 2 MOTOR SPEEDS

FUNCTIONAL CHARACTERISTICS

Display	Analogic
Supply	Electric
Timer	Linear scale
Number of motors	3
Motor speeds	2
Max cooking temperature	280°C
Core probe	-
Cooking chamber material	AISI304
Opening door	Right handle
Chimney	50mm open
Humidification	Direct injection
Air injection	-
Self-washing	Standard



STANDARDS

Certification	CE
---------------	----

TRAYS

Trays rack	Wire PA-BIV 10/80 mm
Max tray load	4kg

DIMENSIONS

Oven size with handle WxDxH	818 x 893 x 1318,4 mm
Oven size without handle WxDxH	818 x 827,5 x 1318,4 mm
Chamber size WxDxH	660 x 490 x 948 mm
Unit weight	128kg

PACKAGING

Packaging	Pallet + carton box
Packaging size WxDxH	895 x 970 x 1460 mm
Unit weight with packaging	144kg

ELECTRICAL DATA

HEATERS 5kW 50/60Hz

Power	15,8kW
Frequency	50/60Hz
Power supply	380-415V 3N~
Amperage	25,2A
Power cord req.	5G4

WATER CONNECTION REQUIREMENTS

Humidification Water Inlet	3/4" M Gas threaded
Washing Water Inlet	-
Water drain	30mm
Max water hardness	5°f
Water pressure requirement min-max	150-200 kPa

CONSUMPTION

Humidification Water	22,4l/h max consumption
Rinse Water @2barG	-
Short Washing Water @2barG	-
Long Washing Water @2barG	-
Short Washing Detergent *	-
Long Washing Detergent *	-



CONNECTIVITY

USB	-
Bluetooth	-
Wi-Fi	-
Cloud	-

ACCESSORIES

Self clean system kit	-
Oven stand	TA8274H17X - TA8274H30X TA8274H40X - TA8274H40S TA8274H49X - TA8274H49S TA8274H70X - TA8274H70S TA8274H80X - TA8274H80S
Stand wheel kit	R100
Hood (Air)	-
Hood (Water)	POCPMWF1 - POCPMWF2
External Core probe	-
Sous vide probe	-
Proofer	-
Stacking kit for 2 ovens	SKCP66
Smoker	SMK02
Blast Chiller	-
Blast chiller stacking kit	SK43
Water softner cover	WS10
Water softner 6800l	WS11
Water softner 12000l	WS12
Water pressure adapter	WPA
Water shower kit	S1
Detergent 6kg	DT2
Detergent 10kg	DT4



◆ Standard ◇ Optional - Not available

TYPE OF COOKINGS	
Convection cooking	30°C - 260°C - 86°F - 500°F
Combi cooking	30°C - 230°C - 86°F - 446°F
Steaming cooking	30°C - 130°C - 86°F - 266°F
Static cooking	-
Delta T cooking	-
Core probe cooking	-
Sous vide cooking	-
Low temperature cooking	-
DISPLAY AND CONNECTIVITY	
Type of display	ANALOGIC
Multi-language display	-
Unit set F° or C°	◇
Venix cloud	-
Wi-fi	-
Ethernet port	-
Web server	-
Usb port	-
SETTINGS	
Infinity time set	◆
Chimney set	OPEN
Fan speed set	1/2
Dehumidification set	-
Humidity set	0-100%
Preheat set	MANUAL
RECIPE COOKING	
User recipes book	-
Factory recipes book	-
Cooking cycles	-
Recipes with name and picture	-
Fast recipe selection buttons	-
SPECIAL CYCLE	
Multi-level mix ALL IN	-
Multi-level mix ALL OUT	-
Food regeneration	-
Overnight cooking	-
Overnight self clean	-
Cook & hold	-



Multi-timer	-
Routine program	-
Proofing	-
Fast Cooling	-
Automatic washing system / Rinse	-
Fast start	-
Recipe scheduling	-
Holding / Mass production	-

TECHNICAL FEATURES

Cooking chamber material	AISI304
Second core probe	-
Insertion of the trays	HORIZONTALLY
Fast loading Pro	-
Glass door	DOUBLE
Easy clean internal glass	◆
High performance thermal insulation	YES
Break drop nebulizer	◆
Lightning	LED ON THE DOOR
Direct injection humidification	◆
Boiler humidification	-
Opening door	NOT REVERSIBLE (RIGHT HANDLE)
Reversing fan	◆
Heavy duty reversing fan	◆
Phase cut speed control	-
Inverter speed control	-



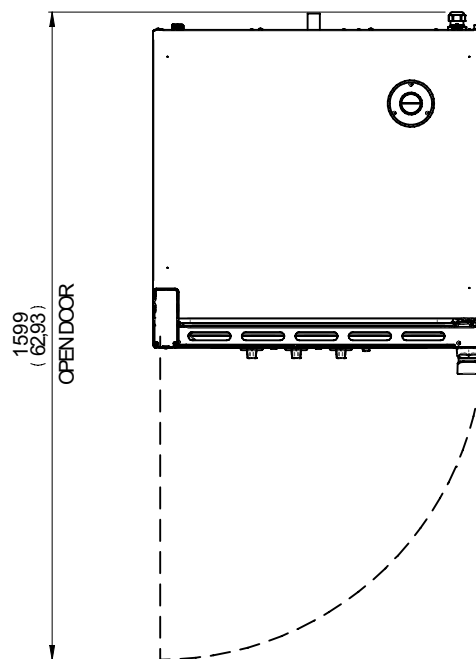
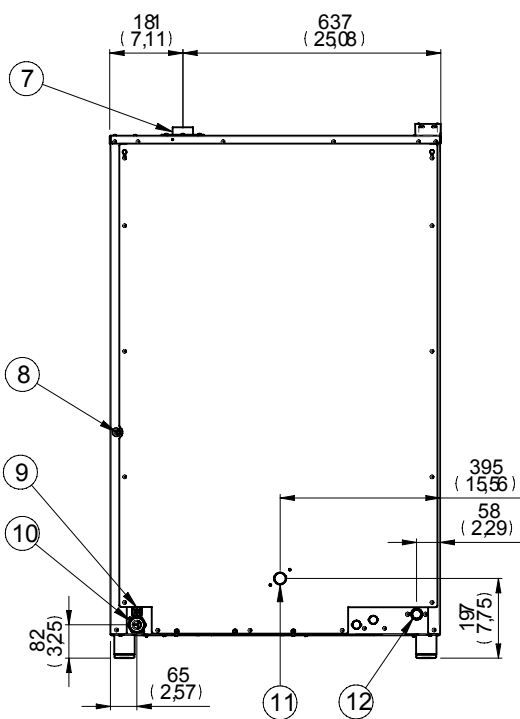
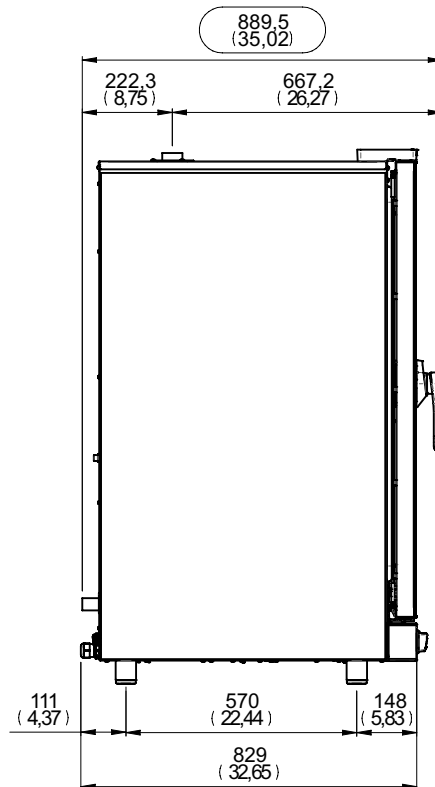
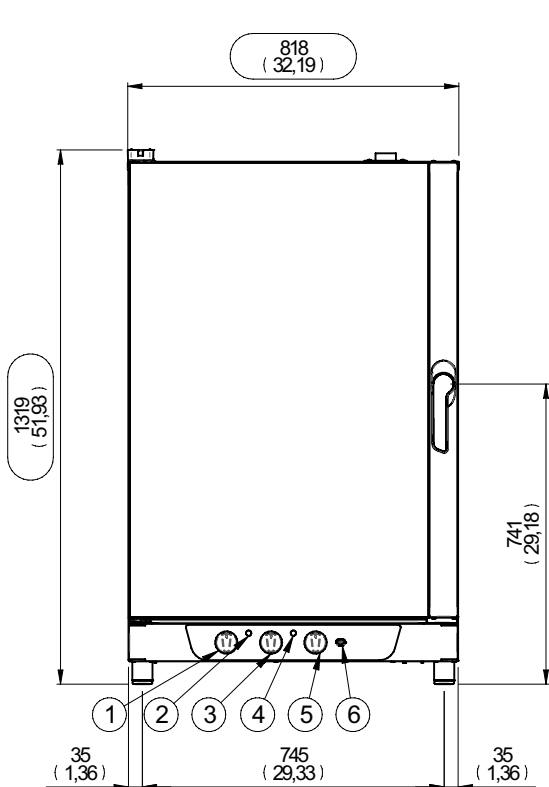

01.	TIMER SELECTOR
02.	LIGHT ON/OFF HEATING ELEMENT
03.	TEMPERATURE SELECTOR
04.	STEAM LED
05.	STEAM SELECTOR
06.	DOUBLE SPEED BUTTON (only if provided)
07.	HOT VAPOUR CHIMNEY Ø50MM (1,97")

08.	SAFETY THERMOSTAT
09.	UNI-POTENTIAL TERMINAL
10.	COMPRESSION CABLE GLAND
11.	DRAIN PIPE Ø30MM (1,18)
12.	WATER IN-LET SOLENOID VALVE G3/4" (HU-MIDIFICATION)

